



No Onward Chain Right Choice Estate Agents are delighted to offer to the market this detached bungalow located on the highly desirable Hill Road. The property offers an entrance hallway leading to three double bedrooms, a generous kitchen/dining room, living room, bathroom and convenient w/c. Additional features include a large private rear garden offering potential to extend subject to planning permission and ample driveway parking.

Location: Oakley is a highly sought-after village on the outskirts of Basingstoke, offering the perfect blend of countryside charm and everyday convenience. With a welcoming community, local shops, well-regarded schools, traditional pubs and scenic walks nearby, it is ideal for families, professionals and downsizers alike. Excellent road and rail links via Basingstoke provide easy access to London, Winchester and the wider Hampshire area, while the surrounding countryside gives Oakley a peaceful village feel.

Tenure: Freehold

Local Authority: Basingstoke & Deane Borough Council - Band E

Viewing Details: Strictly by appointment only. Please Contact Right Choice Estate Agents





Energy Efficiency Rating		Current	Potential
<i>Very energy efficient - lower running costs</i>			
(92 plus) A			
(81-91) B			
(69-80) C			
(55-68) D		68	78
(39-54) E			
(21-38) F			
(1-20) G			
<i>Not energy efficient - higher running costs</i>			
England & Wales	EU Directive 2002/91/EC		

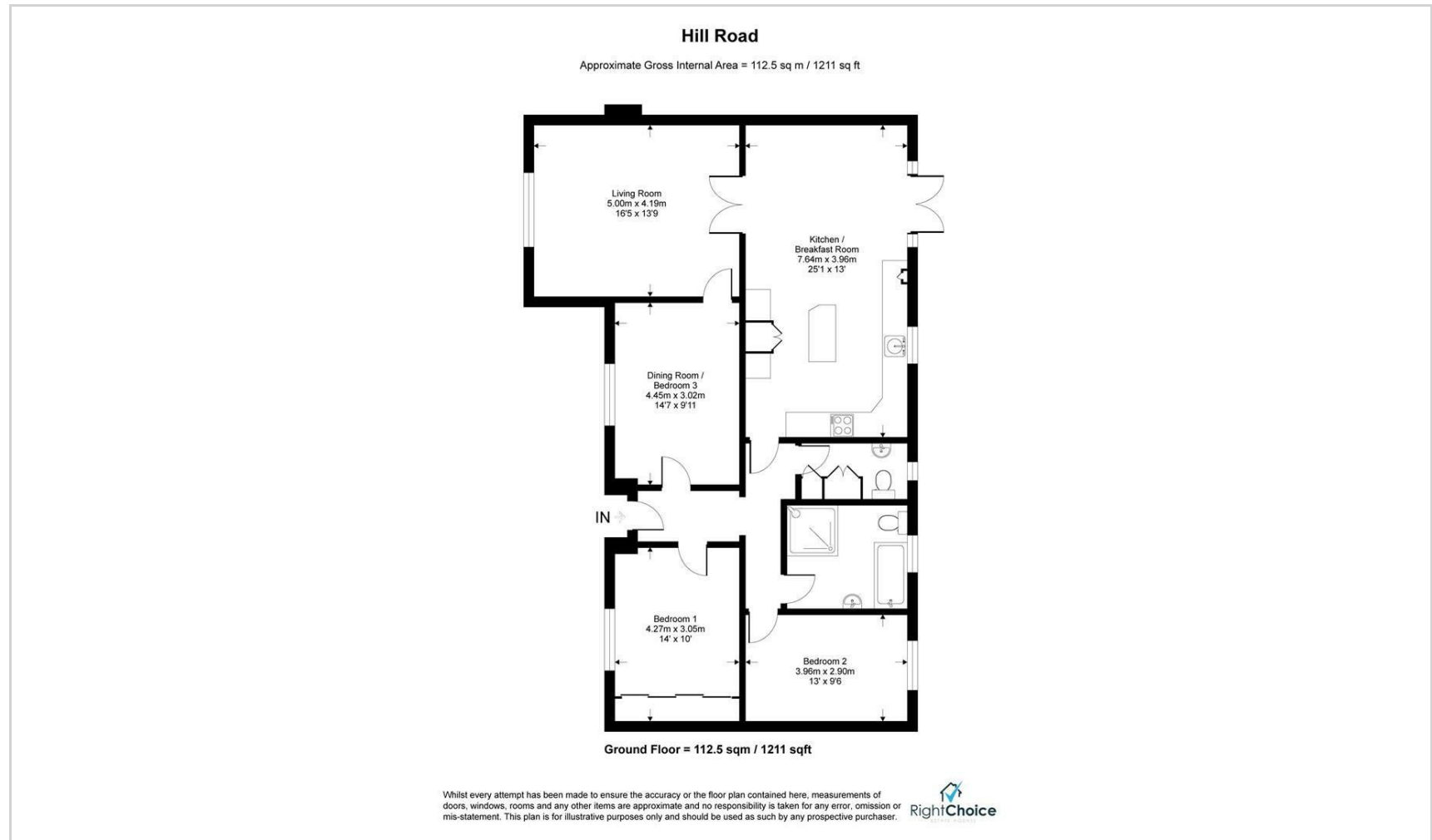

We endeavour to make our sales particulars accurate and reliable, however, they do not constitute or form part of an offer or any contract and none is to be relied upon as statements of representation or fact. Any services, systems and appliances listed in this specification have not been tested by us and no guarantee as to their operating ability or efficiency is given. All measurements have been taken as a guide to prospective buyers only, and are not precise. It is the responsibility of your appointed legal representative to ensure all relevant documentation is present and the property is suitable for purchase. If you require clarification or further information on any points, please contact us, especially if you are travelling some distance to view. Fixtures and fittings other than those mentioned are to be agreed with the seller by separate negotiation. Right Choice Estate Agents is a trading name of Right Property Choice Limited, 72 Beecham Berry, Basingstoke, Hampshire, England, RG224QN, Registered No: 14505100